

11.1 Introduction

This chapter provides referential information such as service data and exploded views.

11.2 Wiring Diagram

For wiring diagram, see information below.



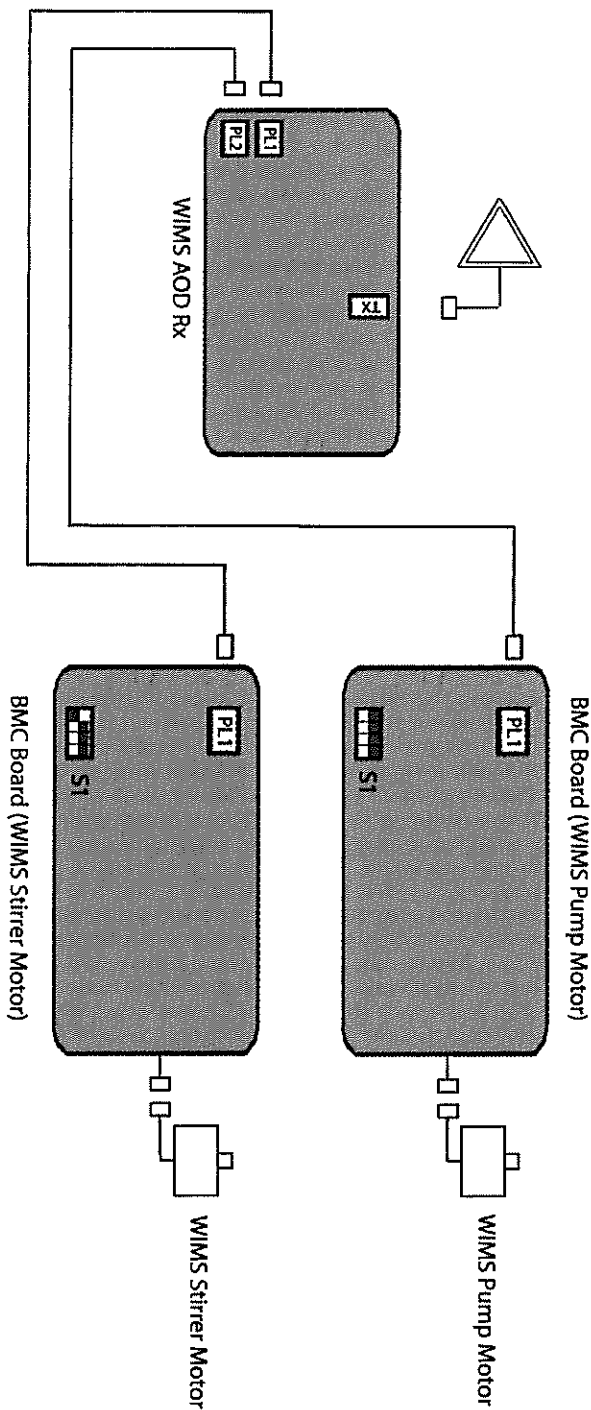

11.3 Maintenance Part List

NOT COMPLETE

TABLE 11-1 MAINTENANCE PART LIST			
Section Name	Part Name	Part Ref	Part Number
Cover section	Panel unit assembly	DF-48977	
	Panel cable assembly	DF-49014	
	Front cover receiver assembly	DF-49056	
	Scroller receiver roller assembly	DF-49063	
	Roll receiver R assembly	DF-49066	
	Roll receiver L assembly	DF-49067	
	Cover R sensor assembly	DF-49011	
	Cover L sensor A0 assembly	DF-49013	
	Sensor cover L assembly	DF-49057	
	Sensor cover R assembly	DF-49058	

TABLE 11-1 MAINTENANCE PART LIST

Section Name	Part Name	Part Ref	Part Number
Board section	Power board assembly	DF-48975	
	Cooling fan assembly	DF-49023	
	Main board (TMPR) assembly	DF-49714	
	SODIMM 128 assembly	DF-49715	
	SODIMM 256 assembly	DF-48716	
	Noise filter assembly	DF-48981	
	Cooling fan cable A1 assembly	DF-48998	
	Noise filter cable A0 assembly	DF-49006	
	Noise filter FG assembly	DF-49019	
	Cooling fan (24V) assembly	DF-49022	
	PF motor assembly	DF-49020	
	PF motor cable A1 assembly	DF-48989	
	PF motor cable A0 assembly	DF-48990	
	X speed reduction belt assembly	DF-49046	
	PF_ENC A1 assembly	DF-48984	
	PF_ENC A0 assembly	DF-48985	
PF driving section	PF_ENC scale assembly	DF-49028	
	Sliding bearing assembly	DF-49048	
	Grid roller bearing assembly	DF-49049	
	Sliding support assembly	DF-49050	
	Speed reduction pulley assembly	DF-49051	

TABLE 11-1 MAINTENANCE PART LIST

Section Name	Part Name	Part Ref	Part Number
CR section	CR motor assembly	DF-49021	
	CR motor cable A1 assembly	DF-48991	
	CR motor cable A0 assembly	DF-48992	
	CR driven pulley assembly	DF-49047	
	CR belt A1	DF-49044	
	CR belt A0	DF-49045	
	CR_HP sensor, lever sensor	DF-49471	
	Lever sensor cable assembly	DF-49004	
	CR origin sensor cable assembly	DF-49000	
	CR Encoder Strip A1 assembly	DF-49024	
	CR Encoder Strip A0 assembly	DF-49025	
	CR Encoder Strip spring assembly	DF-49026	
	Fence guide assembly	DF-49027	
	Pressure arm assembly	DF-49052	
	Pressure roller assembly	DF-49053	
	Pressure roller shaft assembly	DF-49054	
	Pressure spring assembly	DF-49055	
	Tube guide A1 assembly	DF-49039	
	Tube guide A0 assembly	DF-49040	
	Steel bearer A1 assembly	DF-49042	
	Steel bearer A0 assembly	DF-49043	
	CR cable A1 assembly	DF49015	
	CR cable A0 assembly	DF49016	
	Ink tube 1 A1 assembly	DF-49032	
	Ink tube 1 A0 assembly	DF-49034	
	Tube clamp assembly	DF-49041	
	Ink tube 2 A1 assembly	DF-49033	

TABLE 11-1 MAINTENANCE PART LIST

Section Name	Part Name	Part Ref	Part Number
Carriage section	CR board assembly	DF-48976	
	Print head assembly	DF-49029	
	Head cable assembly	DF-49017	
	Damper assembly	DF-42229	
	Cutter solenoid assembly	DF-42234	
	Solenoid spring assembly	DF-49062	
	Cutter spring	DF-44025	
	CR_ENC assembly	DF-48986	
	P_EDGE assembly	DF-48983	
	Head fixing material	DF-49068	
	Solenoid terminal assembly	DF-49003	
	PG origin sensor terminal assembly	DF-49001	
	Head FG assembly	DF-49018	
	Head tube A assembly	DF-49036	
	Head tube B assembly	DF-49037	
	Tube clamp	DF-49041	
	Carriage assembly	DF-49064	
	Roller arm assembly	DF-49065	
	Suction fan	DF-46328	
	Suction fan cable 1 assembly	DF-48994	
	Suction fan cable 2 assembly	DF-48995	
	Suction fan cable 3 assembly	DF-48996	
	Suction fan cable 4 assembly	DF-48997	
	Lock arm assembly	DF-49059	
	Lock arm spring assembly	DF-49060	

TABLE 11-1 MAINTENANCE PART LIST

Section Name	Part Name	Part Ref	Part Number
Media guide section	P_REAR sensor assembly	DF-48982	
Maintenance section	Waste fluid sensor cable assembly	DF-48987	
	Waste fluid sensor cable 2 assembly	DF-48988	
	Wiper origin cable assembly	DF-49002	
	Pump cap assembly	DF-49030	
	Flushing tray assembly	DF-49038	
	Pump motor cable assembly	DF-48993	
	Cleaner head assembly	DF-49031	
Accessory assembly	Power cable assembly	DF-47788	
Others	A0 leg assembly	DF-49069	
	Caster with a lock assembly	DF-49070	
	Free caster assembly	DF-49071	
	Basket cloth A1 assembly	DF-49072	
	Basket cloth A0 assembly	DF-49073	
	Stay cap assembly	DF-49074	
	Arm holder assembly	DF-49075	
	Book holder assembly	DF-49076	
	Basket arm assembly	DF-49077	
	Basket stay A1 assembly	DF-49078	
	Basket stay A0 assembly	DF-49079	
	Inshulock tie (200M)	DF-42281	
	K1 tie (100MM)	DF-42280	
	RoHS adaptation kit	DF-49601	

11.4 Jigs and Tools

This section provides lists of jigs and tools required for service operations.

11.4.1 Required Tools

(1) Tools for Part Replacement

No.	Name	Part Number	Remarks
1	Phillips driver No.2	Generic product	More than 250mm shaft length is recommended
2	Phillips driver No.2	Generic product	Less than 50mm shaft length is recommended
3	Phillips driver No.1	Generic product	
4	Flat-head driver	Generic product	
5	Longnose plier	Generic product	
6	Tweezers	Generic product	
7	Hex wrench (opposite side: 6mm)	Optional stand accessory (Generic product)	Required only when disassembling legs
8	Head washer jig assembly	JD-30410	- Including optional rubber bush, mini fitting - Required four sets per product
9	Rubber bush	JD-42052	Consumable (To be replaced every 20 times)
10	Mini-fitting	JD-42053/Generic product	Manufacturer: Iuchi Seideou
11	Shipping liquid S46 (C)	JD-42263	Volume: 18 liters

TABLE 11-2 TOOLS FOR PART REPLACEMENT

(2) Tools for Adjustment

No.	Name	Part Number	Remarks
1	Personal computer	Generic product	
2	Tension gauge	Generic product	Max. 10,000gf (100N) for measurement
3	Tension gauge	Generic product	Max. 4,000gf (40N) for measurement
5	Coated paper	Exclusive use media	For print quality adjustment
6	Straight scale (1000mm)	Generic product	
7	Jig cutter holder	JD-42715	
8	PG height check tool	JD-42624	
9	Tension base B	JD-42618	
10	Tension base A	JD-30693	
11	Rounded spring type tension	JD-42622	
12	Tension adjusting screw	JD-42620	
13	Tension fixing screw	JD-42619	
14	O-ring A0040G	JD-42621	
15	Pan-head machine screw M4	JD-42623	
16	Tension arm	JD-30692	
17	PF encoder adjusting jig	JD-42632	

TABLE 11-3 TOOLS FOR ADJUSTMENT

11.4.2 Required Screws

No.	Name
1	Pan-head machine screw M2 x 4
2	Pan-head machine screw and flat washer M3 x 5
3	Binding head machine screw M3 x 12, Ni-3
4	Tapping screw M4 x 6, S tight cup
5	Tapping screw M4 x 8, S tight cup
6	P tight binding screw M4 x 10, Ni-3
7	Tapping screw M4 x 12, P tight binding (black)
8	P tight cup screw M3 x 6, Ni-3
9	Pan-head machine screw M4 x 30
10	Pan-head screw with spring washer and flat washer M3 x 6
11	Pan-head screw with spring washer and flat washer (polished) M3 x 20
12	Pan-head screw with spring washer and flat washer (polished) M4 x 6
13	Cup screw M3 x 6, Zn-CM2
14	Countersunk head screw, Zn-CM2
15	Pan-head screw with spring washer and flat washer (polished) M2 x 6, Ni-3
16	Pan-head screw with spring washer and flat washer M3 x 8
17	Pan-head screw with spring washer and flat washer M4 x 8
18	Tapping screw M3 x 8, P tight cup
19	Cup screw M4 x 8, Ni-3
20	Tapping screw M3 x 6, S tight cup
21	Tapping screw M4 x 16, S tight cup
22	Pan-head screw with spring washer and flat washer M3 x 8, Ni-3
23	Binding head machine screw M3 x 5, Ni-3bk
24	S tight cup M3 x 6, Ni-3
25	Tapping screw M3 x 8, S tight cup
26	Joint screw M6
27	Joint screw M7
28	S tight binding screw M2 x 8, Zn-CM2
29	Tapping screw M3 x 10, S tight cup
30	Pan-head machine screw M4 x 5, Ni-3
31	Pan-head machine screw M4 x 8
32	Pan-head screw with flat washer (polished) M4 x 20
33	Pan-head screw with spring washer and flat washer (polished) M4 x 40
34	Cup screw M2 x 6, Ni-3
35	Hexagon socket head screw with spring washer and flat washer M3 x 6, Ni-3

TABLE 11-4 REQUIRED SCREWS

11.5 Exploded View

For exploded views and the maintenance parts, see information below.





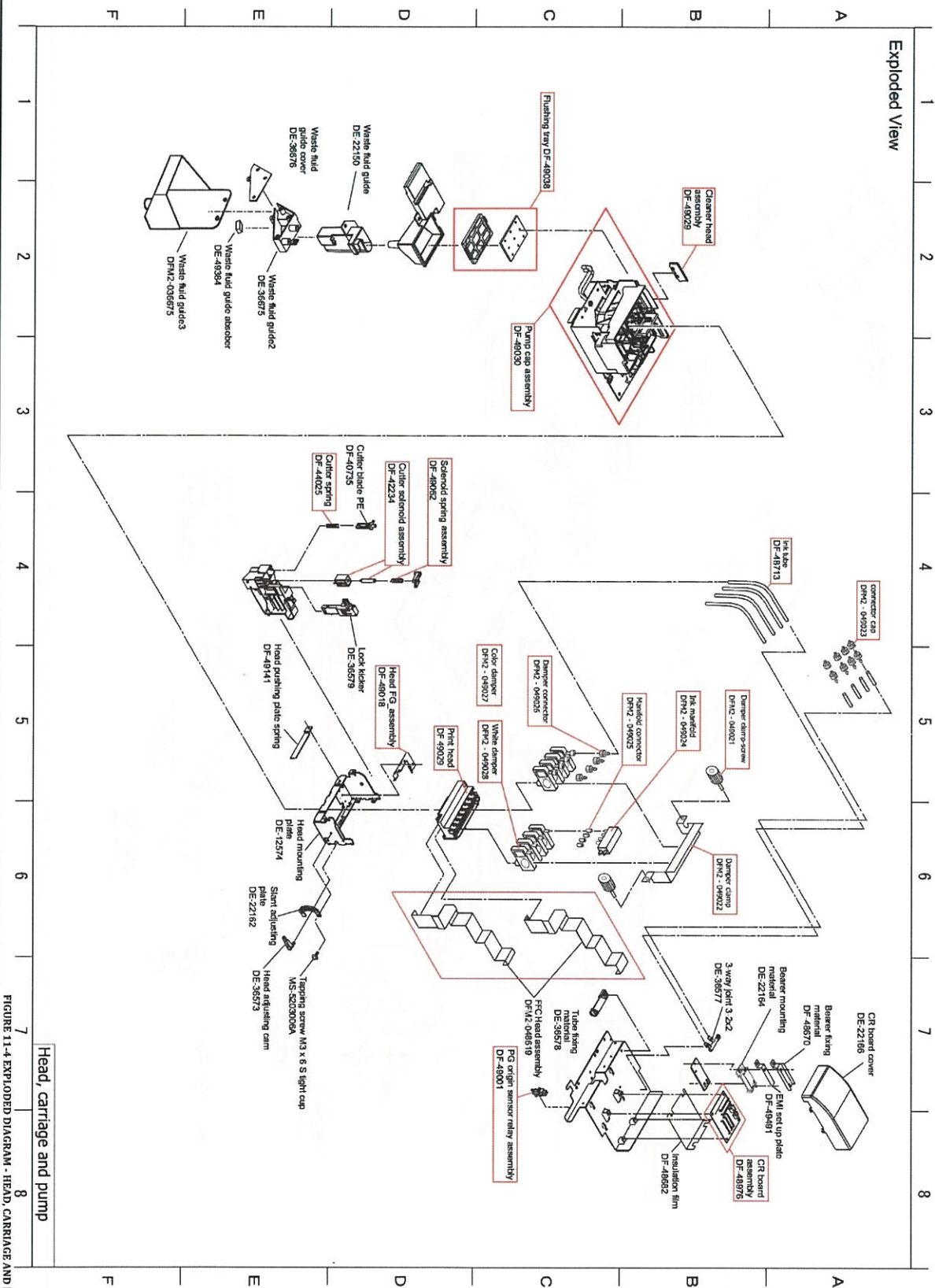

FIGURE 11-4 EXPLODED DIAGRAM - HEAD, CARRIAGE AND PUMP

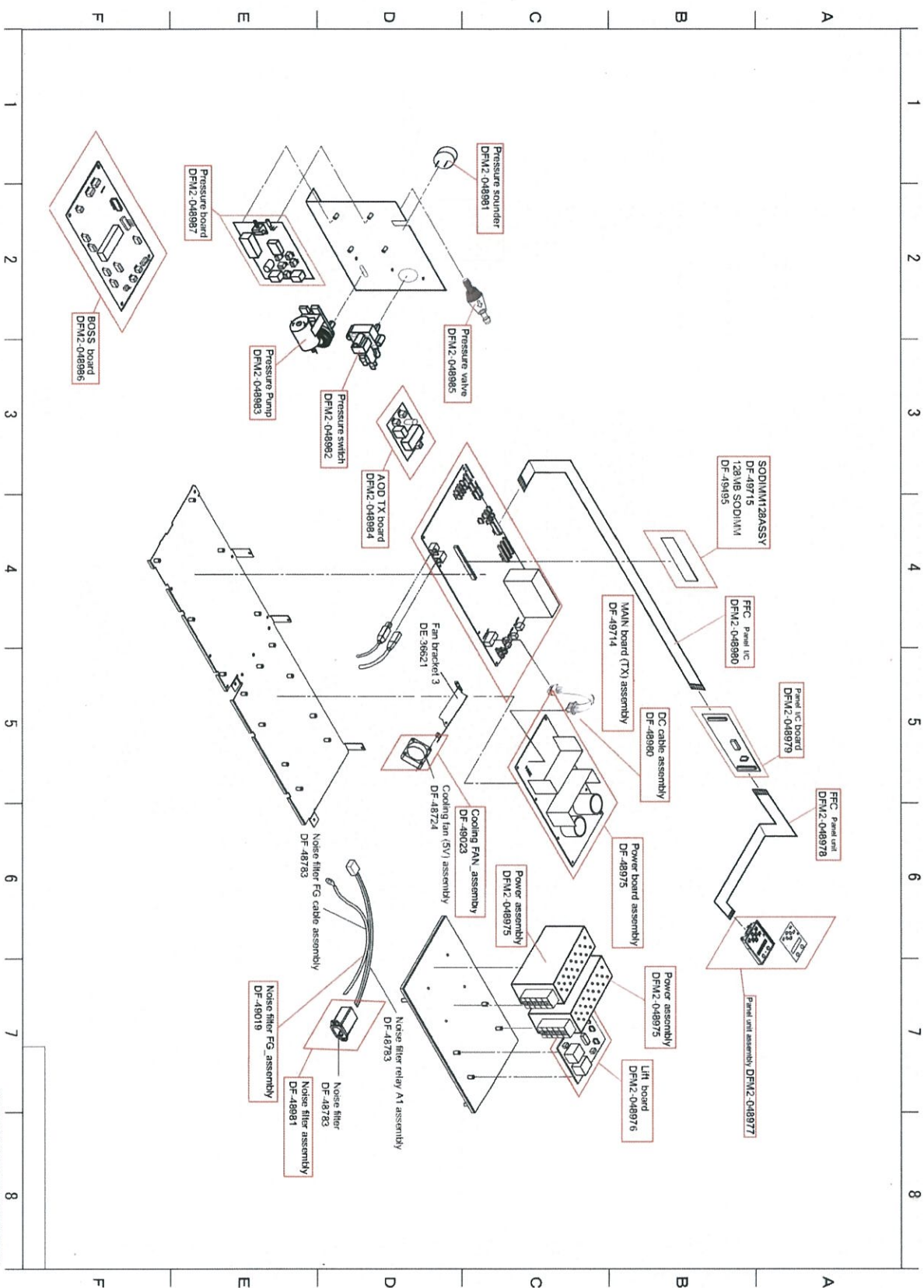

FIGURE 11-5 BOARD BASE SECTION