

1-6 CHASSIS

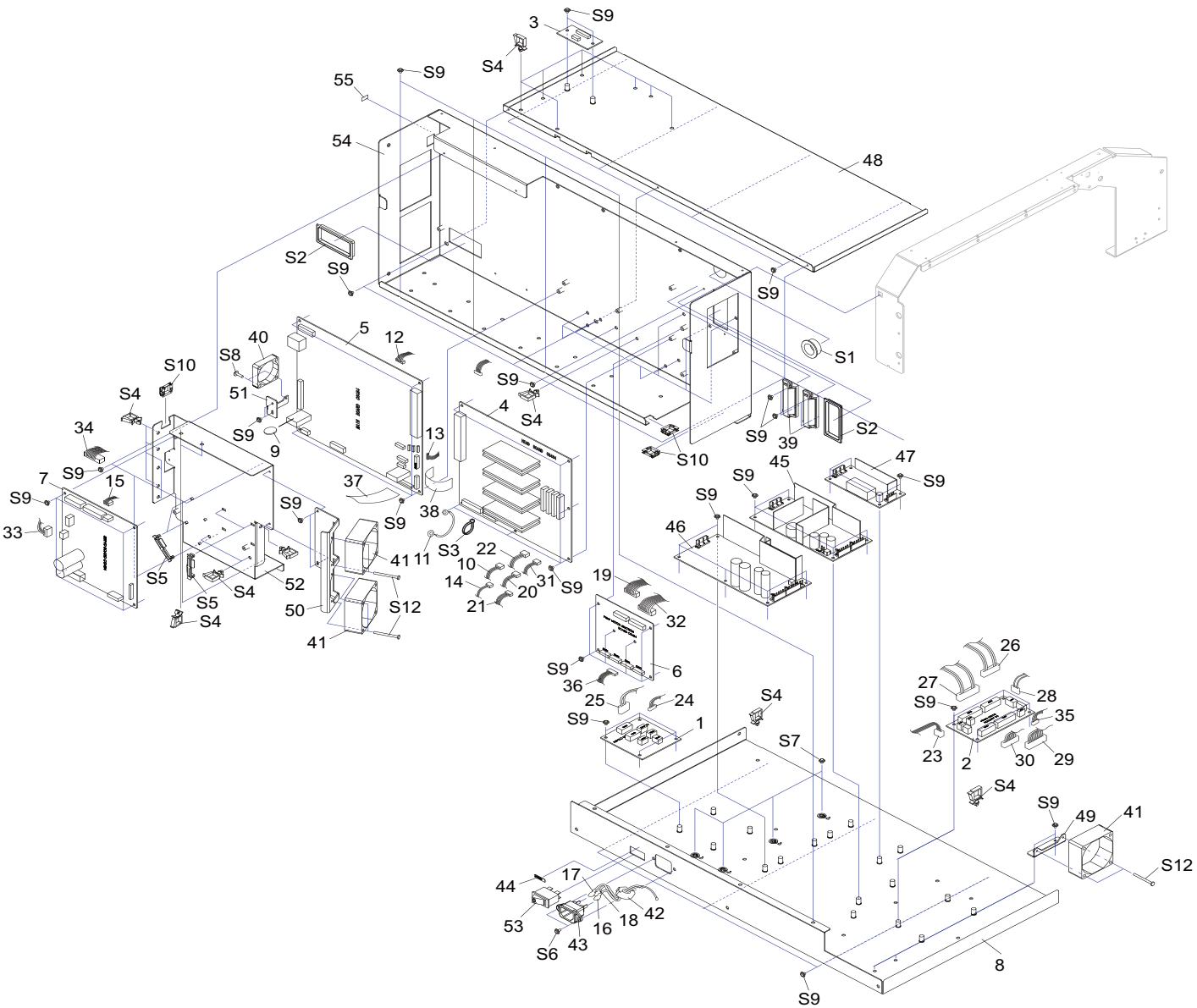

1-6 CHASSIS

PARTS LIST -Main Parts-

	Parts No.	Parts Name	qt.
1	W702048220	ASSY,AC JUNCTION XF-640	1
2	W702048230	ASSY,DC JUNCTION XF-640	1
3	W702048250	ASSY,GRIT ENCODER XF-640	1
4	6702048020	ASSY,HEAD BOARD XF-640	1
	6702048021	ASSY,HEAD BOARD XF-640_01	1
5	6702049000	ASSY,MAIN BOARD XF-640	1
6	6702048060	ASSY,PUMP DRIVE BOARD XF-640	1
7	6702048000	ASSY,SERVO BOARD XF-640	1
8	1000010129	BASE,CHASSIS POWER XF-640	1
	15009101	BATTERY CR2032	1
10	1000009943	CABLE-ASSY M-COVER R XF-640	1
11	23415266	CABLE-ASSY,ESD SJ-1000	1
12	1000009968	CABLE-ASSY,EXT IF TU XF-640	1
13	1000009966	CABLE-ASSY,EXT IF XF-640	1
14	1000009942	CABLE-ASSY,F-COVER SW XF-640	1
15	1000009949	CABLE-ASSY,GRIT ENC XF-640	1
16	23415212	CABLE-ASSY,JUNBI A SJ-1000	1
17	23415213	CABLE-ASSY,JUNBI B SJ-1000	1
18	23415257	CABLE-ASSY,JUNBI G SJ-1000	1
19	1000009957	CABLE-ASSY,M-CAN XF-640	1
20	1000009944	CABLE-ASSY,M-COVER L XF-640	1
21	1000009941	CABLE-ASSY,PAPER-SENS XF-640	1
22	1000009945	CABLE-ASSY,PINCH SENSOR XF-640	1
23	1000009967	CABLE-ASSY,POWER EXT IF XF-640	1
24	1000009409	CABLE-ASSY,POWER-AC-DC FH-740	3
25	1000009585	CABLE-ASSY,POWER-AC-JUNC XR-640	1
26	1000009937	CABLE-ASSY,POWER-DC24 XF-640	1
27	1000009938	CABLE-ASSY,POWER-DC41 XF-640	1
28	1000009936	CABLE-ASSY,POWER-DC5 XF-640	1
29	1000009940	CABLE-ASSY,POWER-HEAD XF-640	1
30	1000009950	CABLE-ASSY,POWER-SERVO XF-640	1
31	1000010267	CABLE-ASSY,PRI-CAR ORG XF-640	1
32	1000009946	CABLE-ASSY,PUMP-CAN XF-640	1
33	1000009962	CABLE-ASSY,SCAN MTR POWER XF-640	1
34	1000009947	CABLE-ASSY,SCAN MTR SENS XF-640	1
35	1000009939	CABLE-ASSY,SLEEP CTL XF-640	1
36	1000009955	CABLE-ASSY,WIPER XF-640	1
37	1000009969	CABLE-CARD,22P 150L BB HIGH-V	1
38	1000010301	CABLE-CARD,24P1 960L BB HIGH-V	1
39	11769118	CLAMP,FCM2-S6-14	2
40	1000008025	FAN,109P0405M911	1
41	1000006174	FAN,9A0624H414	3
42	12399353	FILTER(E) TFT-081813N	1
43	13429702	INLET AC-P01CF01 15A250V	1
44	22535117	LABEL,POWER CM-500 NO.893	1
45	1000010043	POWER UNIT,ZWS150BAF-24/R	1
46	1000010044	POWER UNIT,ZWS240BP-48/R (41)	1
47	1000010042	POWER UNIT,ZWS30B-5	1
48	1000010132	STAY,CHASSIS COVER XF-640	1
49	22715327	STAY,CHASSIS FAN FJ-540	1
50	1000010359	STAY,CHASSIS FAN HB XF-640	1

	Parts No.	Parts Name	qt.
51	1000010135	STAY,CHASSIS FAN MB XF-640	1
52	1000010133	STAY,SERVO BOARD XF-640	1
53	13129171	SW,POWER AJ8201BF	1
54	1000010130	BASE,CHASSIS BOARD XF-640	1
55	1000002682	LABEL,LAN VP-540#LA964	1

Revised 12

PARTS LIST -Supplemental Parts-

	Parts No.	Parts Name	qt.
S1	31029101	BUSH,NB-19	1
S2	31029106	BUSH,SQUARE SB-6025	2
S3	31329601AS	CLAMP SET,INSULOK T-18S 100 PCS.	3
S4	31409811AS	SADDLE SET,LOCKING WIRE LWS-1211Z 20P	45
S5	3000000030	CLAMP,WIRE PRESS RFC-33V0	4
S6	31289105AS	CUPSCREW SET, M3*6 3CBC 100 PCS	2
S7	31289111AS	CUPSCREW SET, M4*6 NI 100 PCS.	4
S8	31799103	SCREW SET,CAP M3*15 NI 20PCS	2
S9	31289109AS	CUPSCREW SET,M3*4 NI 100 PCS.	67
S10	31409702	SADDLE SET,LOCKING WIRE LES-1010 20P	3
S11	3000000216	SADDLE,WIRE WS-2N-V0	76
S12	31019124	SCREW SET,BINDING M3*35 NI 50 PCS	6

* qt. indicated the number of parts that is described in the figure.

Revised 12 :Refer to the Service Information XF640-006.