



Reinitialize the Limit

Step By Step Procedure

for VP & RS models

Do It Yourself Guide

Reinitialize The Limit - Do It Yourself Guide

Reinitialize The Limit is the process of telling the printer several vital pieces of information that can be lost for various reasons.. These pieces of information are, the home position and the cut down position. When both of these factors are known the machine will then understand the width or printable area. Head crashes are the most common cause of needing to Reinitialize The Limit. However, these steps need only be performed if the symptoms below are exhibited.

Symptoms indicating a Reinitialize The Limit may be needed:

When powering the machine on the model type is listed as XX-??? For example VP-??? or RS-???

When "Sheet Cut" is performed the carriage performs the motion but does not engage the cutter correctly.

Carriages are disconnected error occurs repeatedly.

Scan Motor errors occur repeatedly.

This is a simple process that when performed correctly takes just a few minutes to complete.

Performing the Reinitialize The Limit process



1. Power the machine **OFF** from the front panel.



2. Remove the two screws that hold the right hand cover and remove the cover.

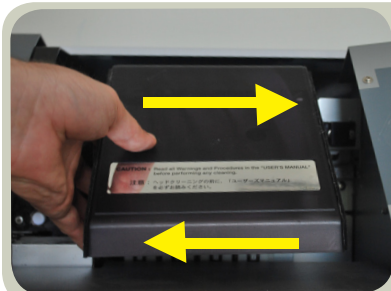

3. Move the **Print Carriage** out of the home position. Press the **Carriage** to the **Right** and then gently move it back towards the **Left**.

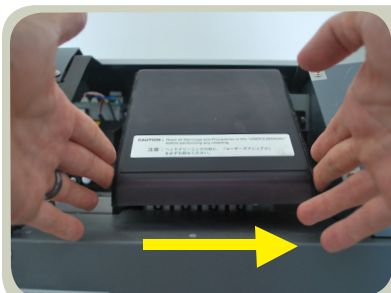

4. Once freely moving, return the **Print Carriage** to the lock position on the right. Once the **Print Carriage** reaches the correct position an audible "click" will be heard indicating the lock has been engaged. **Do not move the Print Carriage too far to the Right or the Lock will not engage correctly.**

Tech Tip: Locking the Print Carriage takes a steady hand and patience. It may take several attempts before the Lock is achieved. **Do not continue the process without locking the Print Carriage otherwise the process will not complete.**



5. Gently push the **Print Carriage** to the **Left** as shown to insure the Lock is set properly. The **Print Carriage** should not move.



6. Hold the **LEFT, UP, RIGHT Arrow Keys** and **Press the Sub Power Key**. Setting Up The Limit will appear on the LCD panel. **Press Enter**

Continued Next Page

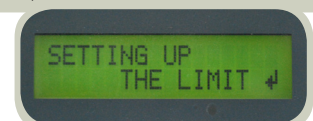

Reinitialize The Limit - Do It Yourself Guide



7. The LCD Panel will now read **DETECTING**. It is at this time the printer will go through a procedure and an error may occur. If an error occurs at this time it is most likely that the Print Carriage was not locked correctly. Power the machine **OFF** and start the process again from **Step 1**.

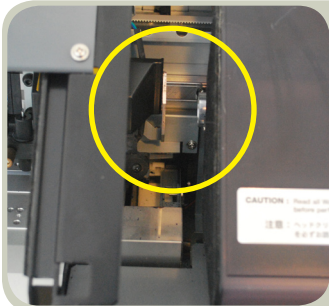

8. Once the home position is set up the LCD Panel will read **"SETTING UP CUTTER DOWN POS"**. At this time the **Cutter Carriage** should have separated from the **Print Carriage**. If the **Cutter Carriage** has not separated from the **Print Carriage** power the machine **OFF** and start the process again from **Step 1**.

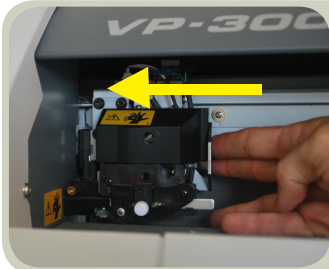

9. Take the **Cutter Carriage** and bring it to the left hand side of the machine and press it firmly against the inner wall to engage the **Sheet Cutter**. The **Sheet Cut Blade** will visibly engage at this time. This action defines the width of the printer and sets the position for engaging the sheet cutting blade.



10. Leave the **Cut Carriage** at the **Left** side of the machine and **Press ENTER** on the control panel. The **Cut Carriage** will return to the right hand side.



11. Shortly after the **Cut Carriage** returns the LCD Panel will read **INITIALIZE COMPLETED**.



12. Power **OFF** the machine and restart as normal. The machine is now ready for use. If the Limit Initialize fails repeat the process from Step 1.

Further Support

Should further support be needed or any additional questions arise about the processes in this document please contact your local supporting dealer. As always, thank you for choosing Roland.