

3-14 FLEXIBLE CABLE REPLACEMENT

Revised 4

This is a procedure to replace the FLEXIBLE CABLE between the SERVO BOARD and the TOOL CARRIAGE.

- 1 Remove the following covers.

LEFT COVER
I/S COVER
FRONT RAIL COVER
FRONT COVER

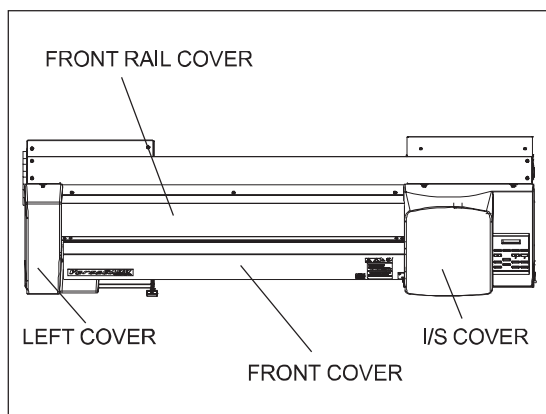

- 2 Turn on the SUB POWER SW while pressing the Left, Right and Down keys to enter the SERVICE MODE.

[◀], [▼], [▶] + POWER ON

[MENU] key

MENU
SERVICE MENU

- 3 Select [CAP&WIPER CTRL] > [CAP] > [OPEN], and press the [ENTER] key. The CAPPING UNIT moves down and allows you to move the HEAD CARRIAGE by hand.

SERVICE MENU
CAP&WIPER CTRL

[▶]

CAP&WIPER CTRL
CAP

[▶]

CAP
OPEN

[ENTER]

- 4 Move the HEAD CARRIAGE slowly leftwards.



Be careful that the head does not strike the media or media clamp.

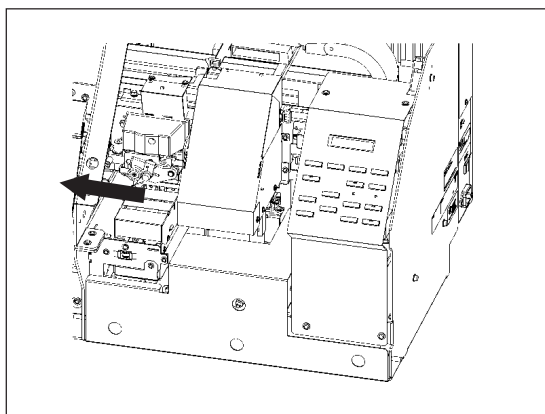

- 5** Remove the ENCODER SCALE by removing the PLATE fixing the ENCODER SCALE at its right end and the SPRING on its left end.

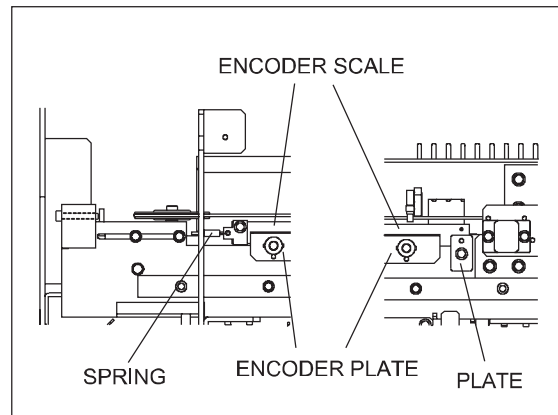

- 6** Turn off the Main Power SW, and disconnect the power cord. Then, remove the CHASSIS COVER.

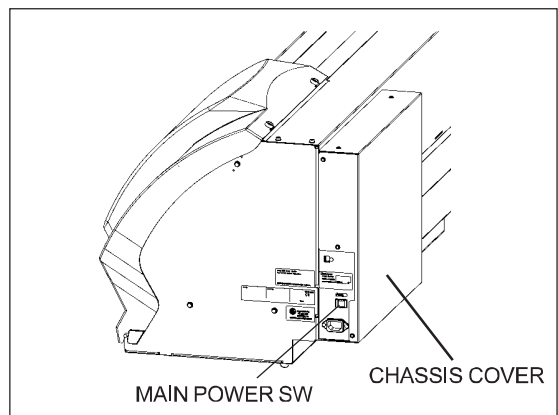

- 7** Disconnect the flexible cable at the CN6 of the SERVO BOARD.

Then, remove the 4 screws fixing the 4 corners of the CHASSIS and open it.



You don't have to take off the CHASSIS from the machine.

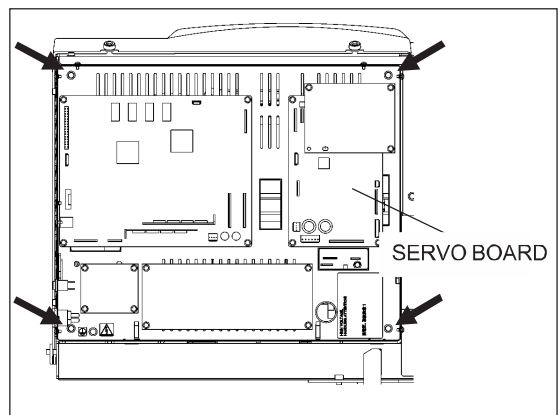

- 8** Remove the 2 CABLE HOLDERS that are holding the FLEXIBLE CABLE on the RAIL, and remove the rivets that are fixing the CABLE GUIDES.

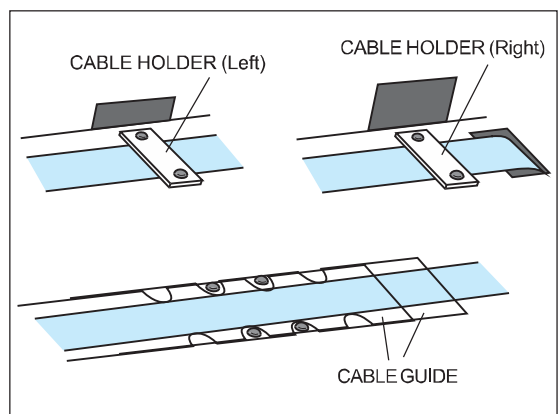

- 9** Remove TOOL CARRIAGE TOP COVER from the TOOL CARRIAGE.

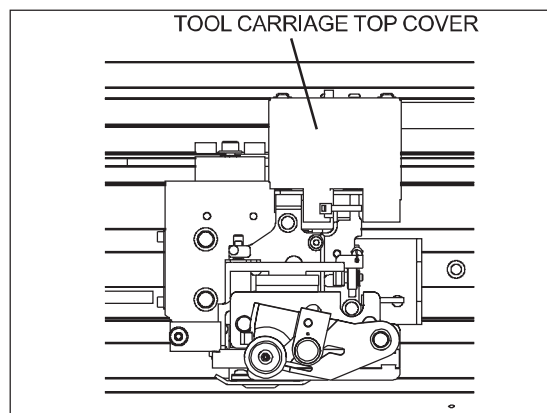

- 10** Disconnect the 3 cables except the FLEXIBLE CABLE from the TOOL CARRIAGE BOARD, and remove the TOOL CARRIAGE BOARD from the machine.

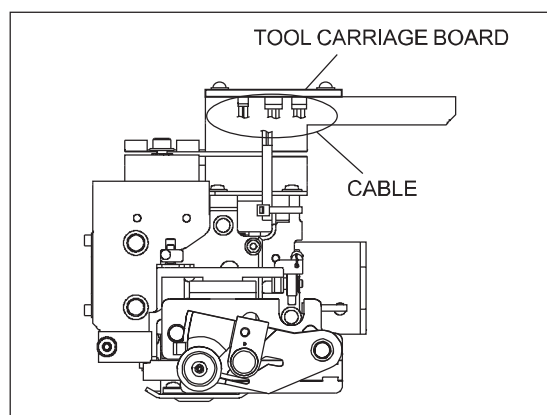

- 11** Remove the FLEXIBLE CABLE and the CABLE GUIDES from the TOOL CARRIAGE BOARD.

- 12** Connect the new FLEXIBLE CABLE to the TOOL CARRIAGE BOARD. Then, fix the 2 new CABLE GUIDES with putting the FLEXIBLE CABLE between them.

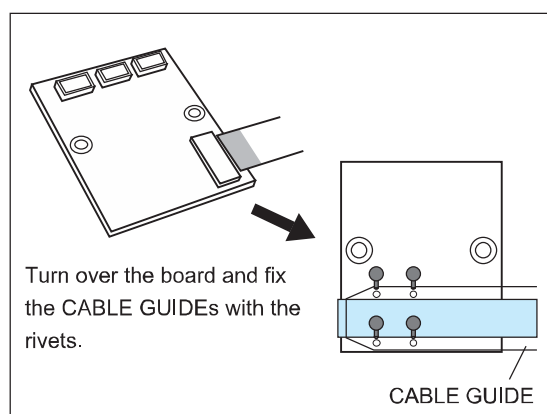

- 13** Fix the CABLE GUIDEs on the RAIL with the rivets.

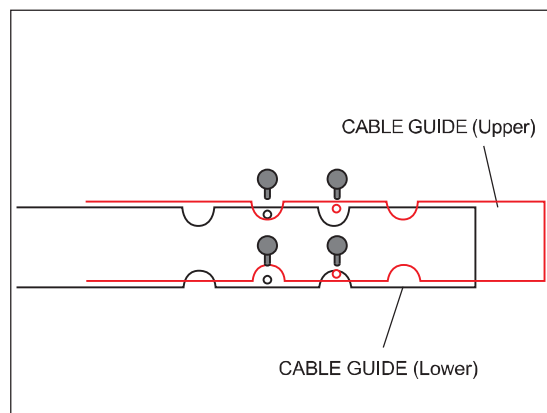

- 14** Connect the FLEXIBLE CABLE to CN6 of the SERVO BOARD.

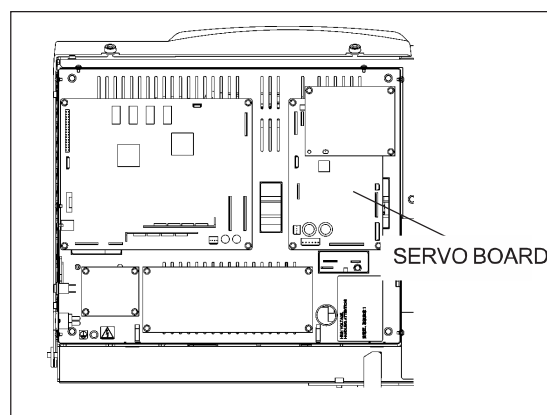

- 15** Pull the FLEXIBLE CABLE rightward with holding the INNER CABLE GUIDE at the left side so that the FLEXIBLE CABLE fits to the INNER CABLE GUIDE.

If the FLEXIBLE CABLE is not pulled enough or pulled too much, there will be the slack in the CABLE GUIDE.

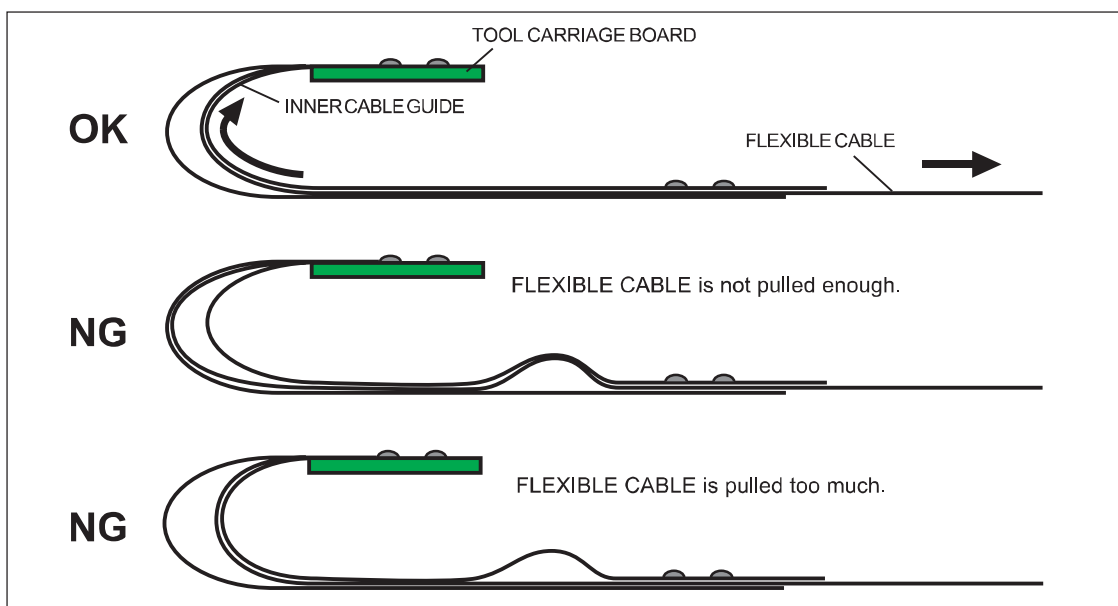

- 16** Fix the FLEXIBLE CABLE with the CABLE HOLDER with keeping the condition of **15**.

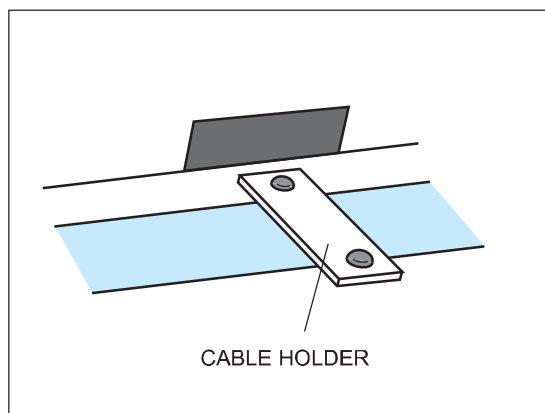

- 17** Fix the FLEXIBLE CABLE with the other CABLE HOLDER.



Fix the CABLE HOLDER with pulling the FLEXIBLE CABLE not to have the slack between the 2 CABLE HOLDERS.

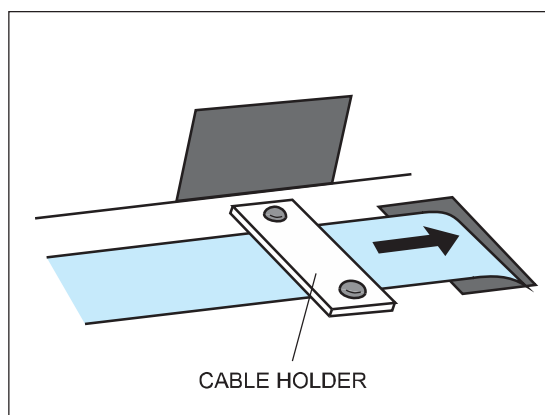

- 18** Fix the TOOL CARRIAGE BOARD to the TOOL CARRIAGE, and connect the 3 cables.

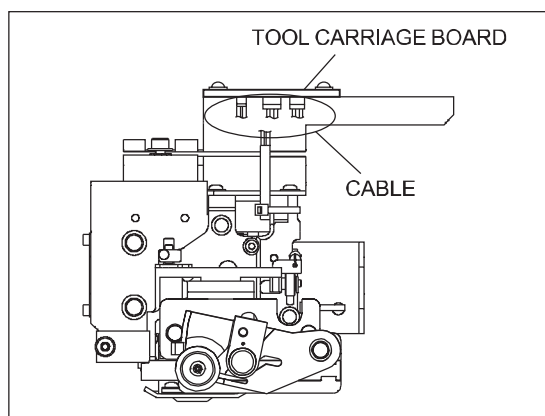

- 19** Put the ENCODER SCALE in between the ENCODER PLATE and the GUIDE RAIL.

Then, fix the right end with the PLATE and hook up the SPRING on the left end.

Make sure that the ENCODER SCALE is in place.



Do not loosen or tighten the screws fixing the ENCODER PLATE.

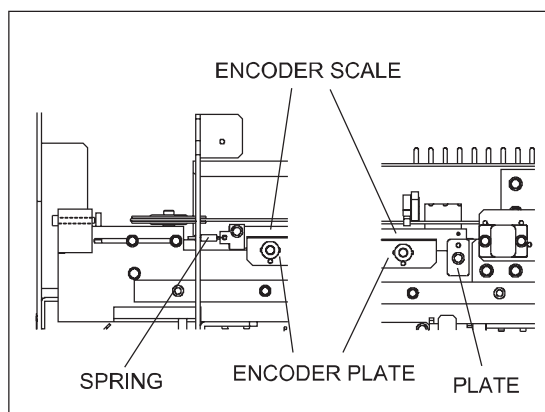

20 Move the HEAD CARRIAGE in a whole width of the machine.

Make sure that the ENCODER SCALE doesn't make contact with the ENCODER MODULE and also ENCODER SCALE is between the slit of the ENCODER MODULE.

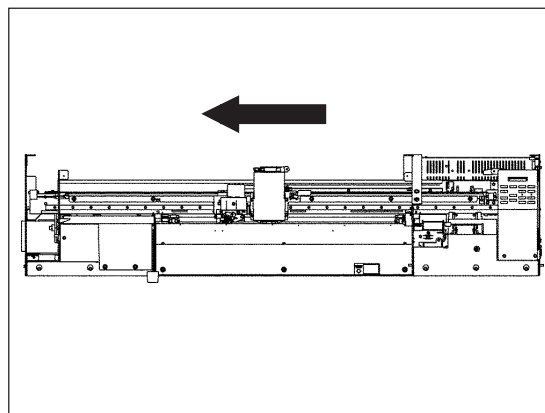

21 Carry out the LINEAR ENCODER SETUP.